

# Mercedes C E CLK W203 W211 W209 Class Door Lock Actuator Spring Repair Instructions Rear Door

## Introduction



Door lock bouncing up and down? Finding it increasingly difficult to lock your Mercedes?

The Springs within the door lock actuator mechanisms deteriorate over time, the OEM spring is made from cheap metal which wears quickly, this wear leads to the symptoms noted above.

Simply install our improved design replacement springs and restore your locks for good.

Made from high quality Stainless Steel (will not deteriorate over time like springs offered by some others) our improved design thicker wound springs will restore your lock and will not deteriorate over time like the OEM part does, save the cost of a replacement actuator that will just fail again.

Mercedes C Class W203 2000-2007

Mercedes E Class W211 2002-2009

Mercedes CLK W209 A209 2002-2009

Parts from X8R Ltd

[www.x8r.co.uk](http://www.x8r.co.uk)

## Step 1: Remove door trim



Remove T20 torx and remove lock cover.

Lever off the cover from the door handle.

Remove the two torx bolts under the handle cover (T25, T30)

## Step 2: Remove door trim - 2



Lever around the edge of the door trim and lift off.

Pull upwards and forwards on the door trim to remove.

Disconnect hook linkage.

Remove insulation to access actuator.

## Step 3: Release actuator

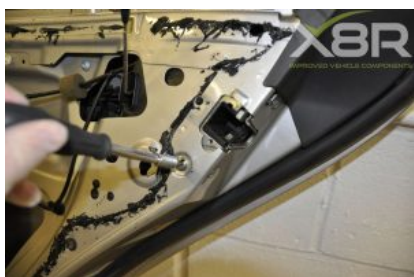

Remove the 3x T30 Torx screws holding the actuator.

If present remove plastic cover.

## Step 4: Remove outer handle

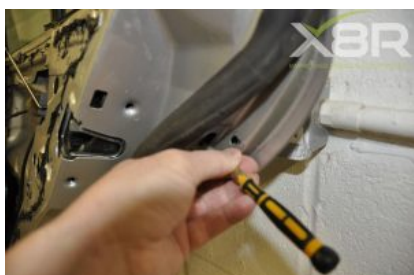
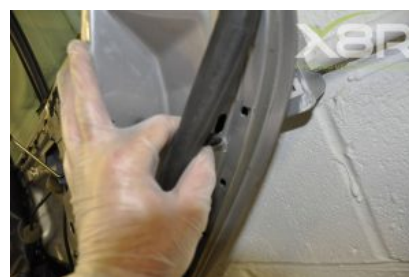



Pry off plastic cover.

Remove blanking plate and unscrew T20 torx holding outer door handle.

Remove handle, firstly remove small part of handle released by removing the previous T20 Torx then slide handle in to recess left from this to release from vehicle.

Remove the two exposed T20 torx screws which will release the bearing clamp.

## Step 5: Remove foam block





Remove foam block, this sits in front of actuator preventing removal.

This consist of two blocks as shown these slide together, slide the two blocks apart and remove.

## Step 6: Remove bearing clamp



Remove bearing clamp.

## Step 7: Remove actuator

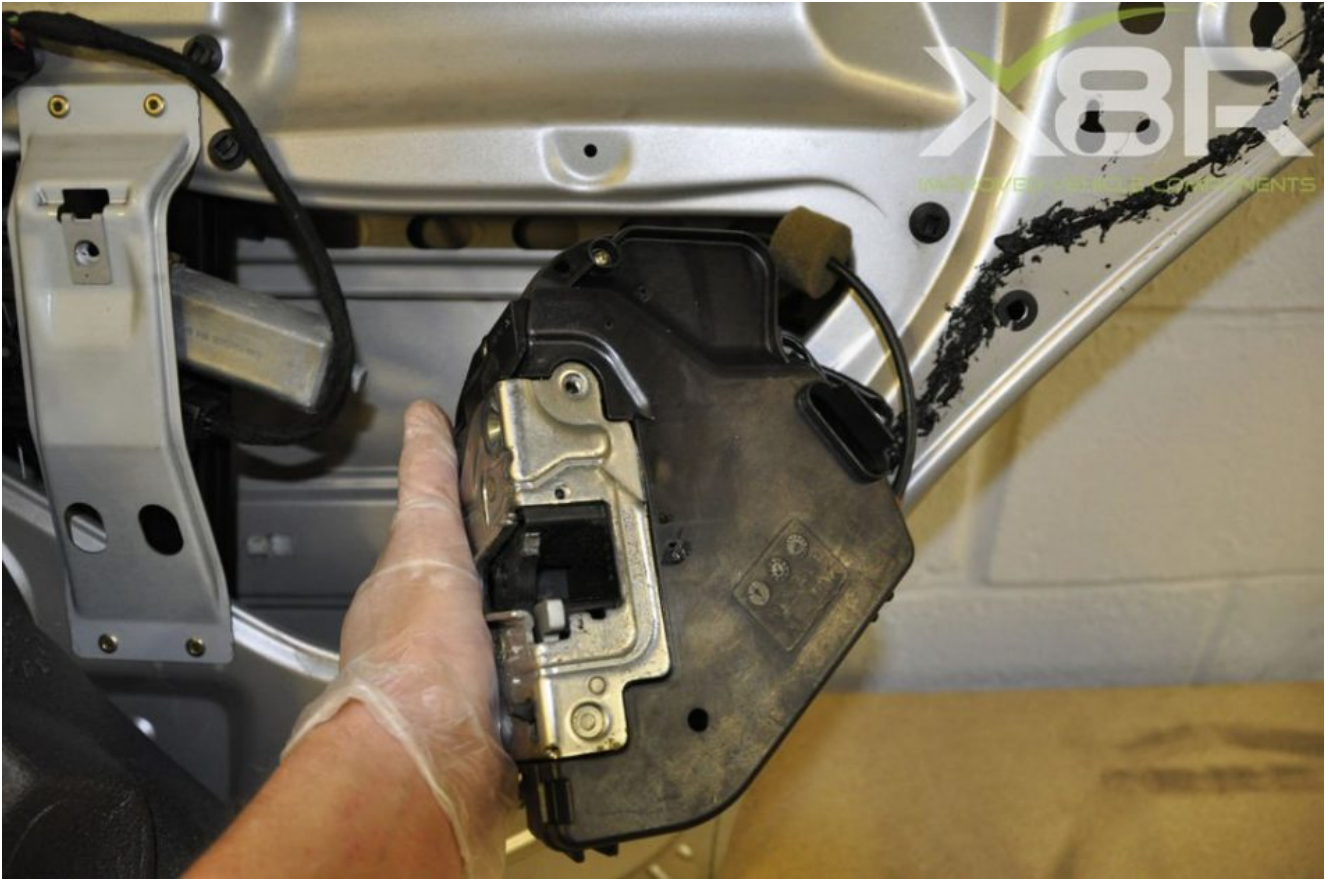

Slide actuator out of position and remove.

## Step 8: Fit replacement spring





Lever off actuator cover.

Replace spring as shown, remove any remains of old spring if in place.

If there are remains of the spring deep in the top white recess it will be hard to remove, you will need to drill this out from directly above using a 1mm drill piece.

Using the pliers insert the top leg of the spring in to the top white recess, if you are unable to do this it is likely that there is still remains of the old spring in place, if so please drill these out as noted above.

Attach pliers firmly to the bottom leg of the spring and force in to bottom recess, some force will be required, do not worry the spring will not snap.

Once in place slide bottom leg of spring in to the smallest part of the recess. Test function to make sure spring is seated correctly; test again when reattaching actuator to vehicle.

If you need any further guidance on this install or would like to purchase the parts shown please call us on +44 01843 446643 or email us at [sales@x8r.co.uk](mailto:sales@x8r.co.uk) .

Please also check out our instruction guide on YouTube. [www.x8r.co.uk](http://www.x8r.co.uk)  
Installation is carried out at installers risk, if unsure please contact us or a professional, X8R Ltd cannot be held responsible for any adverse result of installing this product or any injuries caused by install, if in doubt ask a professional. All images and texts are copyright X8R Ltd 2016.